



Energy Efficient Lighting

B BJ TAKE INC.



High Bay Lighting

Project:
Type:
Date:
Product Code:
Approval:

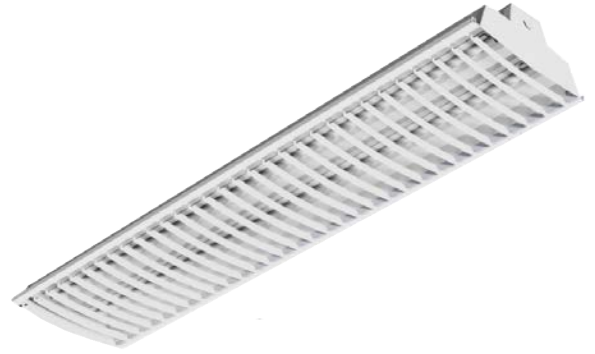

Stylish performance with LED technology.

BLHE - SPECIFICATIONS MAY CHANGE WITHOUT NOTICE

Superior-grade, suspended-mount LED high bay fixture. It has been designed for indoor use where high-efficiency, ease of installation and sturdy construction are primary considerations. Its multi-faceted reflector makes it ideally suited for general area illumination.

FEATURES

- Available in 4' or 8' lengths
- L70 of 120,000 hours
- Radial blade gives fixture a sleek and modern look
- Unique lens design aids in preventing dust from coming into contact with LEDs

OPTIONS

- 4' or 8' lengths available
- Available in 3000K, 3500K, 4000K and 5000K
- 0 - 10V dimming available
- 347V options available

APPLICATIONS

- Retail stores
- Storage areas
- Warehouse facilities

APPROVALS

- Adheres to CSA and UL standards

OPTICS

Powder coated body in high-reflectance white. High-efficiency diffuser maximizes light distribution while providing full diffusion of LED point sources. Specialized LED lens delivers a consistent light to the work surface that is both bright and significantly reduces eye strain.

ELECTRICAL

All components have met all regulatory approvals. Convenient knockout patterns for easy connections and through wiring. Fixture is available in 120 - 277VAC and 347V options.

MOUNTING

Can be row-mounted using a suspended or surface-mount configuration. Optional mounting is available with aircraft cable, chain or stem mounting. Optional mounting bracket for surface mounting.

CONSTRUCTION

Cold rolled steel body is precision formed for strength and rigidity. Utility aluminum module mount provides additional heat syncing capability. Powder coated end caps with knock-outs for continuous wiring.

PRODUCT DIMENSIONS

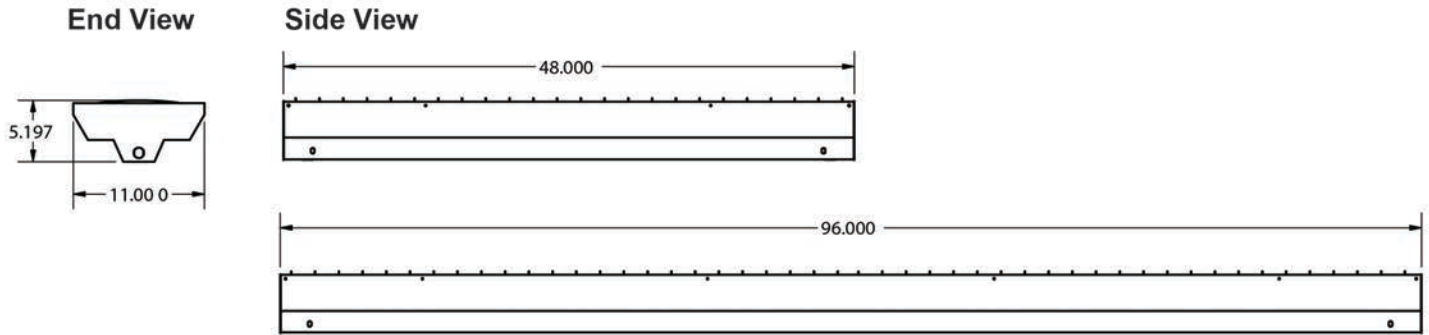

PRODUCT KEY

Fixture Type	Fixture Sizes	Lumen Output (in 1,000s)	Module Type	CRI & Colour Temperature	Driver Voltage	Options
BLHE		L				
	4'	4	ULT	830	UNV	
		6		835	347	
		9		840		
	8'	12		850		
		13.5				
		18				

OPTIONS

Battery Back-Up (Needs to be specified) Hangers M1 - Speedy Hanger (V-Bracket) M3 - Aircraft Cable "Y" Toggle With Cable Gripper (5, 10 and 15') M25 - Surface Mounting Bracket	Louvers and Baffle J4 - Radial Blade Baffle 2" Spacing (11" Wide, 47.75" Long) J31 - Straight Blade Baffle 7/8" High 1 7/16" Spacing (Standard) Sensors W12 - Motion Sensor - 10C W26 - Motion Sensor with Photocell	Wire W1XX - Flexible Whip - 16/4 600V White (XX - Length) W2XX - Flexible Whip - 16/4 600V Black (XX - Length) W3XX - Flexible Whip - 16/3 600V White (XX - Length) W4XX - Flexible Whip - 16/3 600V Black (XX Length) Lens L0 - No Lens
--	---	--

Project:
Type:
Date:
Product Code:
Approval:

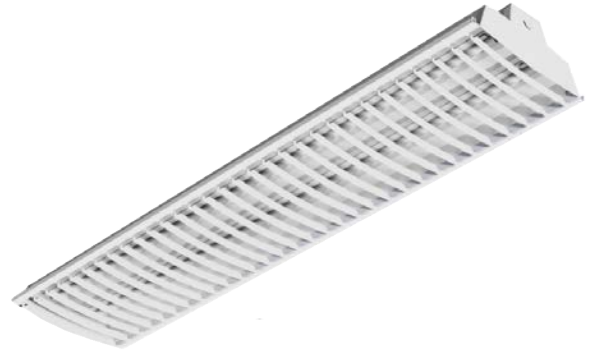

Stylish performance with LED technology.

BLHL - SPECIFICATIONS MAY CHANGE WITHOUT NOTICE

Superior-grade, suspended-mount LED high bay fixture. It has been designed for indoor use where high-efficiency, ease of installation and sturdy construction are primary considerations. Its multi-faceted reflector makes it ideally suited for general area illumination.

FEATURES

- Available in 4' or 8' lengths
- L70 of 120,000 hours
- Unique lens design aids in preventing dust from coming into contact with LEDs

OPTIONS

- 4' or 8' lengths available
- Available in 3000K, 3500K, 4000K and 5000K
- 0 - 10V dimming available
- 347V options available

APPLICATIONS

- Retail stores
- Storage areas
- Warehouse facilities

APPROVALS

- Adheres to CSA and UL standards

OPTICS

Powder coated body in high-reflectance white. High-efficiency diffuser maximizes light distribution while providing full diffusion of LED point sources. Specialized LED lens delivers a consistent light to the work surface that is both bright and significantly reduces eye strain.

ELECTRICAL

All components have met all regulatory approvals. Convenient knockout patterns for easy connections and through wiring. Fixture is available in 120 - 277VAC and 347V options.

MOUNTING

Can be row-mounted using a suspended or surface-mount configuration. Optional mounting is available with aircraft cable, chain or stem mounting. Optional mounting bracket for surface mounting.

CONSTRUCTION

Cold rolled steel body is precision formed for strength and rigidity. Utility aluminum module mount provides additional heat syncing capability. Powder coated end caps with knock-outs for continuous wiring.

PRODUCT DIMENSIONS

End View

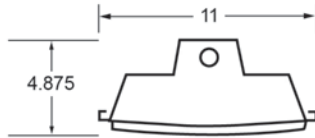

Side View

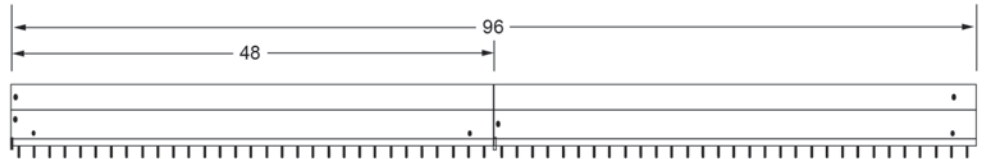

PRODUCT KEY

Fixture Type	Fixture Sizes	Lumen Output (in 1,000s)	Module Type	CRI & Colour Temperature	Driver Voltage	Options
BLHL		L				
	4'	4	ULT	830	UNV	
		6		835	347	
		9		840		
	8'	12		850		
		13.5				
		18				

OPTIONS

Battery Back-Up (Needs to be specified) Hangers M1 - Speedy Hanger (V-Bracket) M3 - Aircraft Cable "Y" Toggle With Cable Gripper (5, 10 and 15') M25 - Surface Mounting Bracket	Louvers and Baffle J4 - Radial Blade Baffle 2" Spacing (11" Wide, 47.75" Long) J31 - Straight Blade Baffle 7/8" High 1 7/16" Spacing (Standard) Sensors W12 - Motion Sensor - 10C W26 - Motion Sensor with Photocell	Wire W1XX - Flexible Whip - 16/4 600V White (XX - Length) W2XX - Flexible Whip - 16/4 600V Black (XX - Length) W3XX - Flexible Whip - 16/3 600V White (XX - Length) W4XX - Flexible Whip - 16/3 600V Black (XX Length)
--	---	---

Project:
Type:
Date:
Product Code:
Approval:

Performance, functionality and long lasting quality.

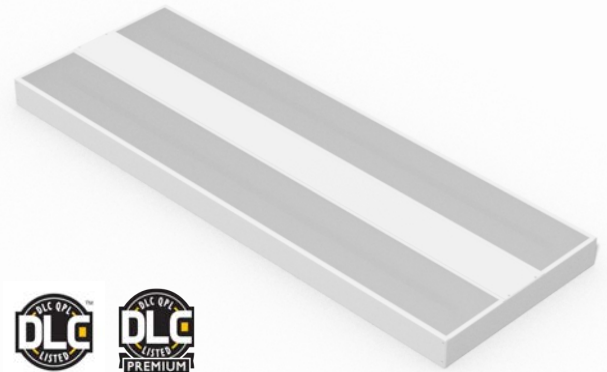

*Consult BJ Take for premium list

BLHP - SPECIFICATIONS MAY CHANGE WITHOUT NOTICE

Superior-grade, suspended mount LED high bay fixture. It is ideal for indoor use, where energy-efficiency, performance and ease of maintenance is essential. Its rugged design and superior light paths make it an ideal fixture for high bay applications.

FEATURES

- Utilizes a high-efficiency LED driver with a universal power supply for 120 - 277V, and 347 - 480V
- L70 of 200,000 hours
- Lensing provides dust protection and uniform light distribution while maximizing the total generated light

OPTIONS

- 0 - 10V dimming standard
- Available in 4000K and 5000K
- Lumen packages are available in 12000, 16000, 24000, 48000, and 70000 lumens
- Consult the product key of this sheet to determine wattage consumption
- Pendant mounting is available
- Wire guard is available

APPLICATIONS

- Warehouse and distribution centers
- Manufacturing
- Retail stores
- Gymnasiums

OPTICS

Pre-painted body in high-reflectance white. High-efficiency diffuser maximizes light distribution while providing diffusion of LED point sources. Optics available for narrow, and standard distribution.

ELECTRICAL

All components have met all regulatory approvals. Fixture is available in 120 - 277V, and 347 - 480V

MOUNTING

Holes provided for S-hook chain-mounting or aircraft cable. Optional pendant mounting is available.

CONSTRUCTION

Pre-painted, high reflectance white body is precision bent for added strength and rigidity. 0.030" nominal thick steel. Access panel for easy wiring. Shallow fixture design provides a clean appearance for many environments.

APPROVALS

- ETL certified
- Damp Rated
- DLC Certified

PRODUCT DIMENSIONS

End View

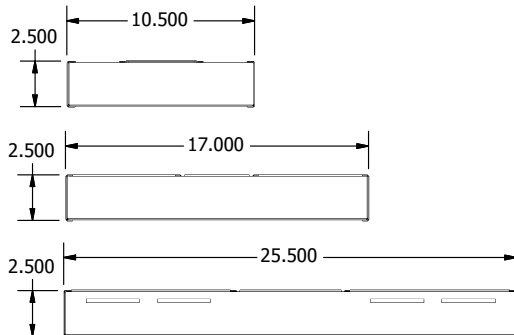

Side View

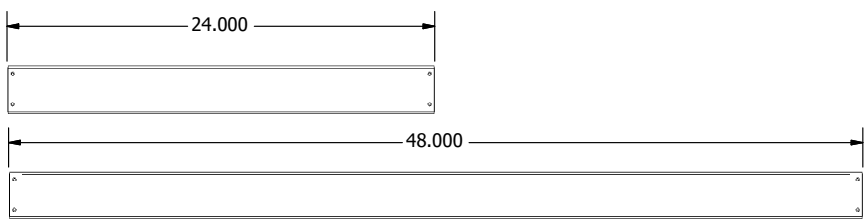

Lumens	Width	Length
12L	10.5"	24"
16L	17"	24"
24L	17"	24"
24L	10.5"	48"
48L	17"	48"
70L	25.5"	48"

PRODUCT KEY

Fixture Type	Fixture Size	Lumen Output	CRI & Colour Temperature	Driver Voltage	Options
BLHP			L		

2'	12	840	UNV
	16		
	24		
4'	24	850	347
	48		
	70		

BLHP Wattages									
Length	Lumens	Wattage	Delivered (5000K)	Delivered (4000K)	Length	Lumens	Wattage	Delivered (5000K)	Delivered (4000K)
2'	12	88.8	11,275	10,980	4'	24	187.2	25,004	24,350
	16	124.8	16,566	16,129		48	374.3	50,330	49,013
	24	187.2	25,004	24,350		70	564.5	73,114	71,201

*Based on UNV voltage

*Based on optix lens

Options

Lenses L0 - No Lens L55 - Clear Acrylic Lens L67 - Optix Lens Wire Guard G1 - Wire Guard (Powder Coated White)	Mounting M3 - Aircraft Cable "Y-Toggle", 5 FT M23 - Aircraft Cable "Y-Toggle", 10 FT M24 - Pendant Mount, 3/4" Hub and a Stabilizer Bracket Motion Sensor W53 - Standard Motion Sensor	Cords W1xx - 16/4 White Cord, Specify Length W2xx - 16/4 Black Cord, Specify Length W3xx - 16/3 White Cord, Specify Length W4xx - 16/3 Black Cord, Specify Length W5xx - Power Cord 16/3, Specify Length and NEMA Code	Optics Blank - Narrow Beam Distribution O1 - Wide Beam Distribution *Consult BJ Take for more options
---	---	--	--

Project:
Type:
Date:
Product Code:
Approval:

Performance, functionality and long lasting quality.

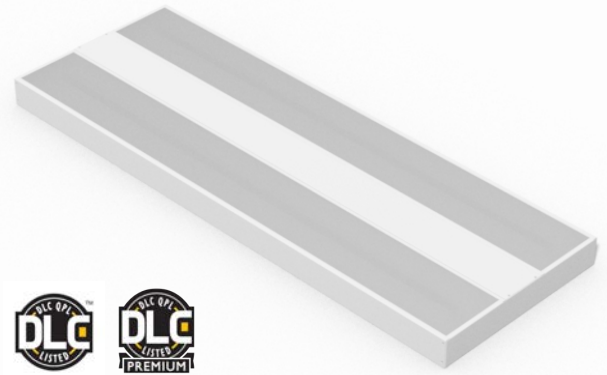

*Consult BJ Take for premium list

BLHPG - SPECIFICATIONS MAY CHANGE WITHOUT NOTICE

Superior-grade, suspended mount LED high bay fixture. It is ideal for indoor use, where energy-efficiency, performance and ease of maintenance is essential. Its rugged design and superior light paths make it an ideal fixture for high bay applications.

FEATURES

- Utilizes a high-efficiency LED driver with a universal power supply for 120 - 277V, and 347 - 480V
- L70 of 200,000 hours
- Lensing provides dust protection, and uniform light distribution while maximizing the total generated light

OPTIONS

- 0 - 10V dimming standard
- Available in 4000K and 5000K
- Lumen packages are available in 12000, 16000, 24000, 48000, and 70000 lumens
- Consult the product key of this sheet to determine wattage consumption
- Pendant mounting is available
- Wire guard is available

APPLICATIONS

- Warehouse and distribution centers
- Manufacturing
- Retail stores
- Gymnasiums

OPTICS

Pre-painted body in high-reflectance white. High-efficiency diffuser maximizes light distribution while providing diffusion of LED point sources. Optics available for narrow, and standard distribution.

ELECTRICAL

All components have met all regulatory approvals. Fixture is available in 120 - 277V, and 347 - 480V

MOUNTING

Holes provided for S-hook chain-mounting or aircraft cable. Optional pendant mounting is available.

CONSTRUCTION

Pre-painted, high reflectance white body is precision bent for added strength and rigidity. 0.030" nominal thick steel. Access panel for easy wiring. Shallow fixture design provides a clean appearance for many environments.

APPROVALS

- ETL certified
- Damp Rated
- DLC Certified

PRODUCT DIMENSIONS

End View

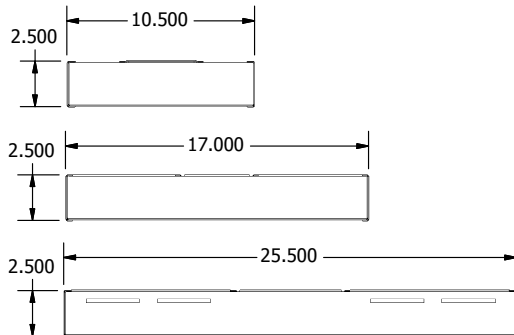

Side View

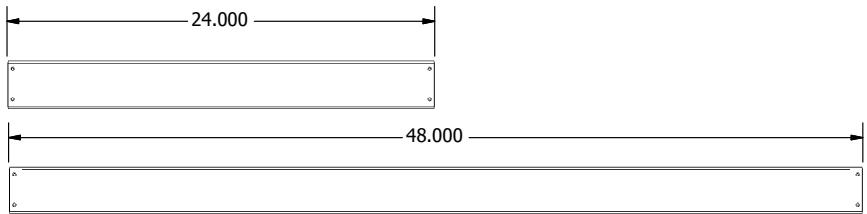

Lumens	Width	Length
10L	10.5"	24"
18L	17"	24"
20L	17"	24"
32L	25.5"	24"
40L	17"	48"
58L	25.5"	48"

PRODUCT KEY

Fixture Type	Fixture Size	Lumen Output	CRI & Colour Temperature	Driver Voltage	Options
BLHPG	-	-	L -	-	-

2'	10	840	UNV
	18		
	20		
	32		
4'	40	850	347
	58		

BLHPG Wattages									
Length	Lumens	Wattage	Delivered (5000K)	Delivered (4000K)	Length	Lumens	Wattage	Delivered (5000K)	Delivered (4000K)
2'	10	90.9	10,755	10,483	4'	40	311.9	41,815	40,755
	18	140.4	18,640	18,168		58	477.1	60,276	58,749
	20	156.0	20,747	20,221					
	32	249.6	33,388	32,542					

*Based on UNV voltage

*Based on optix lens

Options

Lenses L0 - No Lens L55 - Clear Acrylic Lens L67 - Optix Lens Wire Guard G1 - Wire Guard (Powder Coated White)	Mounting M3 - Aircraft Cable "Y-Toggle", 5 FT M23 - Aircraft Cable "Y-Toggle", 10 FT M24 - Pendant Mount, 3/4" Hub and a Stabilizer Bracket Motion Sensor W53 - Standard Motion Sensor	Cords W1xx - 16/4 White Cord, Specify Length W2xx - 16/4 Black Cord, Specify Length W3xx - 16/3 White Cord, Specify Length W4xx - 16/3 Black Cord, Specify Length W5xx - Power Cord 16/3, Specify Length and NEMA Code	Optics Blank - Narrow Beam Distribution O1 - Wide Beam Distribution *Consult BJ Take for more options
---	---	--	---

Project:
Type:
Date:
Product Code:
Approval:



*Dust, vapour and water proof
LED lighting.*

BLHV - SPECIFICATIONS MAY CHANGE WITHOUT NOTICE

Superior-grade, surface and suspended mount LED vapour proof fixture. Its unique, IP67 certified body makes it ideal in environments where vapour-proof efficiency and performance are a factor.

FEATURES

- Fibreglass body with neoprene gasket ensures a dust and water resistant seal
- 4000K and 5000K light colours available
- L70 of 200,000 hours
- 0-10V Dimming Standard

OPTIONS

- Available in 4000K and 5000K
- Lumen packages are available in 8000, 10000, 12000, 14000, 16000, 18000, 20000, 24000, 28000, 32000 and 36000 lumens
- Various diffusers available (consult factory)
- Occupancy and dimming controls
- Available in 2' and 4'

APPLICATIONS

- Food processing plants
- Manufacturing
- Schools
- Storage areas
- Warehouse facilities

OPTICS

Specialized LED lens delivers a consistent light to the area that is bright and evenly distributed. Optics available for narrow, and standard distribution.

ELECTRICAL

All components have met all regulatory approvals. Fixture is available in 120 - 277V, and 347 - 480V

MOUNTING

Can be mounted using suspended or surface-mount configuration.

CONSTRUCTION

Fibreglass enclosure with neoprene gasket ensures a dust and water resistant seal. Impact resistant acrylic lens protects the LED board and driver. End knock-outs allow for continuous wiring.

APPROVALS

- ETL listed product
- Meets IP67 standards
- DLC Listed



PRODUCT DIMENSIONS

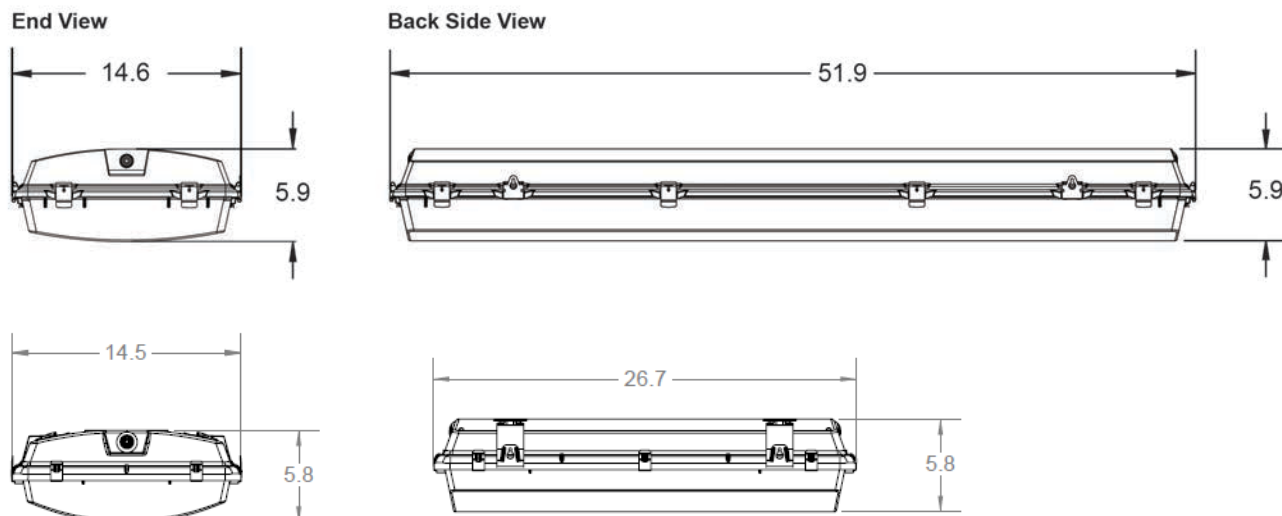

PRODUCT KEY

Fixture Type	Fixture Size	Lumen Output	CRI & Colour Temperature	Driver Voltage	Options
BLHV					

2	8
	10
	12
	14
	16
	18
4	16
	18
	20
	24
	28
	32
	36

840	UNV
850	347
	480

BLHV Wattages							
Length	Lumens	Wattage	Delivered	Length	Lumens	Wattage	Delivered
2'	8	63.0	8,493	4'	16	124.5	16,450
	10	77.8	10,233		18	137.8	18,298
	12	90.0	12,057		20	155.7	20,594
	14	109.0	14,378		24	186.8	24,739
	16	127.6	16,342		28	218.0	28,883
	18	140.1	18,522		32	249.1	33,028
					36	280.2	37,172

*Based on UNV voltage
*Based on a frosted lens
*Based on 4000K

Options

Lenses L26 - Clear Polycarbonate Lens L49 - Frosted Acrylic Lens L55 - Clear Acrylic Lens L59 - Frosted Polycarbonate Lens	Mounting V-Hook Standard M20 - Ceiling Mount V-Hook Motion Sensor W12 - Standard Motion Sensor W26 - Motion Sensor with Photocell W30 - IP Rated Motion Sensor	Cords W1xx - 16/4 White Cord, Specify Length W2xx - 16/4 Black Cord, Specify Length W3xx - 16/3 White Cord, Specify Length W4xx - 16/3 Black Cord, Specify Length W5xx - Power Cord 16/3, Specify Length and NEMA Code	Optics Blank - Narrow Beam Distribution O1 - Wide Beam Distribution *Consult BJ Take for more options
---	--	--	---



Industrial Lighting

Project:
Type:
Date:
Product Code:
Approval:



Performance and style with LED technology.

BLR - SPECIFICATIONS MAY CHANGE WITHOUT NOTICE

Superior-grade, recessed low profile lay-in T-Bar luminaire. Its ideal for indoor use where aesthetics, energy-efficiency and T-Bar mounting is essential. Its low-profile body is ideally suited for shallow, or obstructed plenum installations.

FEATURES

- Available in 1x4, 2x4 and 2x2 dimensions
- 3000K, 3500K, 4000K and 5000K light colours available
- Diffuser provides a uniform lighting surface
- L70 of 120,000 hours
- Type IC

OPTIONS

- Various sizes available: 1x4, 2x4 and 2x2

APPLICATIONS

- Hospitals
- Offices
- Schools

APPROVALS

- ETL listed product

OPTICS

Pre-painted body in high-reflectance white. Frosted flat lens provides even light distribution.

ELECTRICAL

All components have met all regulatory approvals. Fixture is available in 120 - 277VAC and 347V options.

MOUNTING

Holes provided for chain or hanger wire mounting support for T-Bar ceilings.

CONSTRUCTION

Pre-painted, high reflectance white body is precision bent for added strength and rigidity. 0.030" nominal thick steel. Hinged door frame with frosted flat acrylic lens for even light distribution. Shallow fixture design provides a clean appearance for many environments.



PRODUCT DIMENSIONS

End View

1x4

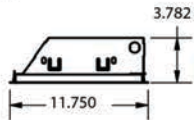

2x2

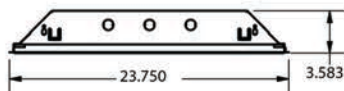

2x4

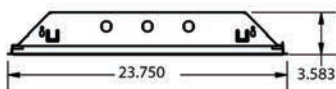

Side View

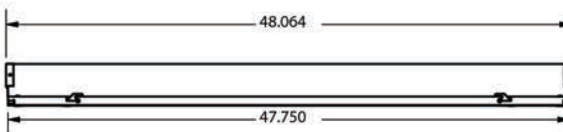
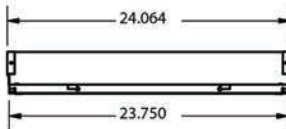
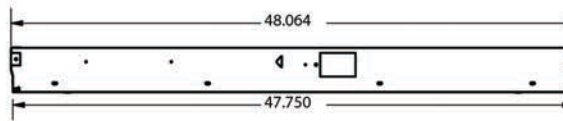

PRODUCT KEY

Fixture Type	Fixture Sizes	Lumen Output (in 1,000s)	Module Type	CRI & Colour Temperature	Driver Voltage	Options
BLR	<input type="text"/>	<input type="text"/> L	<input type="text"/>	<input type="text"/>	<input type="text"/>	<input type="text"/>
	1x4	3	Factory	830	UNV	
	2x4	4	Designated	835	347	
	2x2	6		840		
		8		850		

Wattage Chart

LENGTH	LUMENS	WATTAGE	LENGTH	LUMENS	WATTAGE	LENGTH	LUMENS	WATTAGE
1x4	3	27	2x2	3	27	2x4	4	39
	4	39		4	39		6	52
	6	51		6	51		8	77

OPTIONS

Flange

H14 - Flange (integral) for Drywall Installation

Dimming

W23 - 0 - 10V No Leads (Standard)

W24 - 0 - 10V With Leads

Motion Sensor

W12 - Motion Sensor - 10C

Lens

L19 - Makrolon: LumenXT LC3 LED Frosted Lens

L25 - Eastman Chemicals Developmental Lens

Project:
Type:
Date:
Product Code:
Approval:



Stylish performance and superior craftsmanship.

BLRC - SPECIFICATIONS MAY CHANGE WITHOUT NOTICE

Superior-grade, LED recessed circular drywall fixture. It is ideal for indoor use where energy-efficiency, performance and elegant style are essential. Its unique lens makes it ideally suited for demanding aesthetic applications.

FEATURES

- Made of high quality pre-painted steel with a powder coated circular flange
- Full dimming option standard with all sizes
- 3000K, 3500K, 4000K and 5000K light colours available
- L70 of 120,000 hours

OPTIONS

- 3', 4' and 5' diameters available
- 0 - 10V dimming available
- Available in 3000K, 3500K, 4000K and 5000K

APPLICATIONS

- Offices
- Retail stores

APPROVALS

- Adheres to CSA and UL standards

OPTICS

High-efficiency diffuser maximizes light distribution while providing full diffusion of LED point sources. Specialized LED lens delivers a consistent light to the area that is bright and evenly distributed.

ELECTRICAL

All components have met all regulatory approvals. Fixture is available in 120 - 277VAC and 347V options.

MOUNTING

Holes provided for chain mounting support for T-Bar ceilings.

CONSTRUCTION

Made of high quality pre-painted steel with a powder coated circular flange. White acrylic lens for even light distribution. Body is precision bent for added strength and rigidity and is comprised of 0.030" nominal thick steel.

PRODUCT DIMENSIONS

Front View

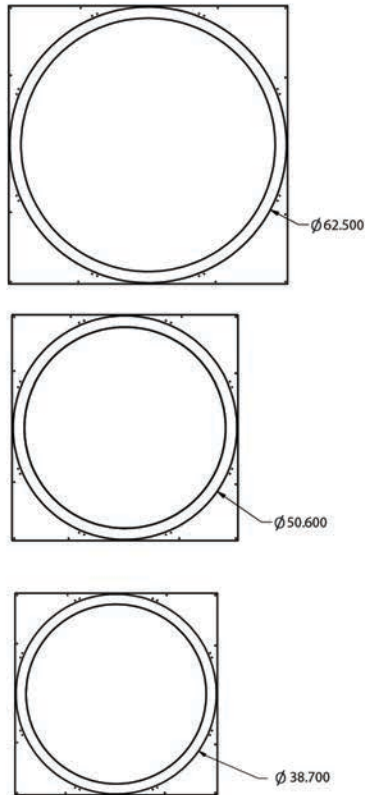

Side View

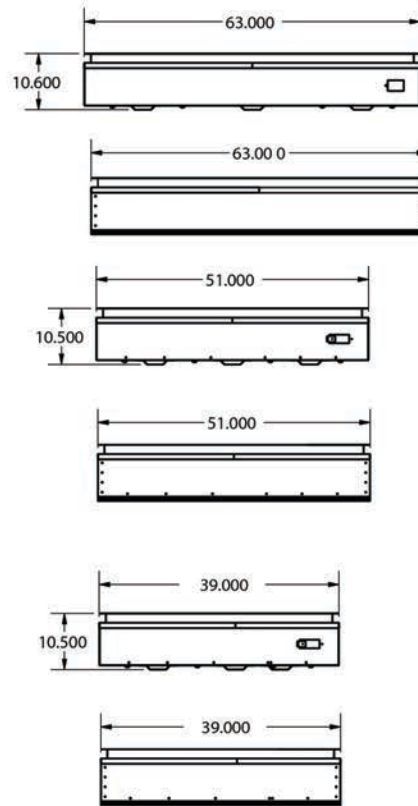

PRODUCT KEY

Fixture Type	Fixture Diameter	Lumen Output (in 1,000s)	Module Type	CRI & Colour Temperature	Driver Voltage	Options
BLRC						
	3'	10	Factory	830	UNV	
	4'	16	Designated	835	347	
	5'	22		840		
				850		

Wattage Chart

LENGTH	LUMENS	WATTAGE	LENGTH	LUMENS	WATTAGE	LENGTH	LUMENS	WATTAGE
3'	10	78	4'	16	150	5'	22	200

OPTIONS

Cords

- W3xx - 16/3 600V White (Specify length)
- W4xx - 16/3 600V Black (Specify length)
- W5xx - Power Cord Twist Lock Plug (Specify NEMA Code)
- W6xx - Power Cord 3-Wire 120V Plug 14/3 (Specify length)
- W8xx - Power cord 3-Wire 120V 5-15P, 16/3

Dimming

- W23 - 0 - 10V No Leads (Standard)
- W24 - 0 - 10V With Leads

Motion Sensor

- W12 - Motion Sensor - 10C

Project:
Type:
Date:
Product Code:
Approval:

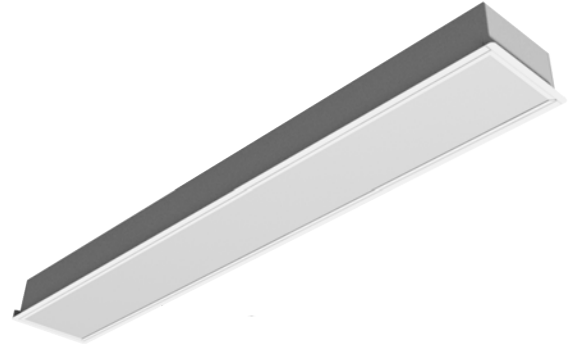

*Performance and cost-effective
LED lighting.*

BLRE - SPECIFICATIONS MAY CHANGE WITHOUT NOTICE

Professional-grade recessed LED strip fixture. It is ideal for indoor use, where energy-efficiency, performance and ease of maintenance is essential. Its narrow recessed design makes it ideal for interior perimeter lighting.

FEATURES

- Various sizes available (consult factory)
- Flange kits are riveted for added strength
- 0-10V dimming standard with all lengths
- L70 of 120,000 hours
- Diffuser provides a uniform lighting surface while maximizing the total generated light

OPTIONS

- Available in various sizes (consult factory)
- Lumen packages are available in 1000, 2000, 3000, 4000, 6000, 8000, and 12,000 lumens
- Flange kit for drywall ceiling

APPLICATIONS

- Coves
- Hospitals
- Indoor recessed applications
- Offices
- Reception areas
- Retail stores

APPROVALS

- ETL listed product

OPTICS

Pre-painted body in high-reflectance white. L70 of 120,000 hours. High-efficiency diffuser maximizes light distribution while providing full diffusion of LED point sources.

ELECTRICAL

All components have met all regulatory approvals. Fixture is available in 120 - 277VAC and 347V options.

MOUNTING

Can be row mounted in a recessed drywall or t-bar application. Holes provided for chain or hanger wire mounting support for T-Bar ceilings.

CONSTRUCTION

Made of high quality and high reflectance pre-painted white steel. Utility grade aluminum module mount provides additional heat syncing capability. This fixture offers a white diffuser to provide uniform lighting while maximizing the total generated light.



PRODUCT DIMENSIONS

THREE INCH WIDE

End View

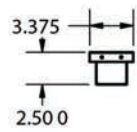

Side View

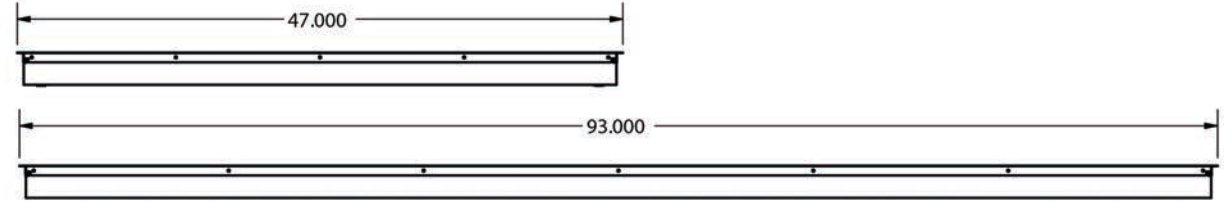

SIX INCH WIDE

End View

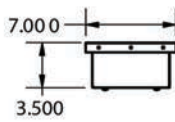

Side View

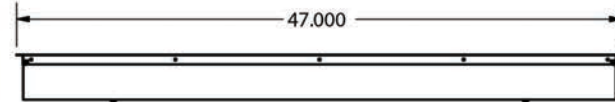

PRODUCT KEY

Fixture Type	Fixture Sizes	Fixture Sizes	Lumen Output (in 1,000s)	Module Type	CRI & Colour Temperature	Driver Voltage	Options
BLRE	<div>3"</div> <div>6"</div>	<div>2'</div> <div>4'</div> <div>8'</div>	<div>1</div> <div>2</div> <div>3</div> <div>2</div> <div>4</div> <div>6</div> <div>4</div> <div>8</div> <div>12</div>	<div>Factory</div> <div>Designated</div>	<div>830</div> <div>835</div> <div>840</div> <div>850</div>	<div>UNV</div> <div>347</div>	

Wattage Chart

LENGTH	LUMENS	WATTAGE	LENGTH	LUMENS	WATTAGE	LENGTH	LUMENS	WATTAGE
2'	1	12	4'	2	19	8'	4	35
	2	22		4	39		8	78
	3	27		6	57		12	114

OPTIONS

Cords W3xx - 16/3 600V White (Specify length) W4xx - 16/3 600V Black (Specify length) W5xx - Power Cord Twist Lock Plug (Specify NEMA Code) W8xx - Power cord 3-Wire 120V 5-15P, 16/3	Lenses L0 - No Lens L18 - Frosted Lens	Dimming W23 - 0 - 10V No Leads (Standard) W24 - 0 - 10V with Leads Motion Sensor W12 - Motion Sensor - 10C
--	---	--

Project:
Type:
Date:
Product Code:
Approval:

**BLRT26**

The BLRT26 is a recessed lay-in fixture designed for use in metric T-bar ceilings and is well suited for use in office spaces where a clean, professional appearance is required.

FEATURES

- Has a full range of voltage options from 120-277V and 347V
- L70 of 125,000 hours
- Fixture lensing provides an even light distribution through the use of extra wide beam angle LED chips and a specially designed extruded lens

OPTIONS

- 0 – 10V dimming standard
- Available in 3000K, 3500K, 4000K, and 5000K
- Lumen packages are available in 4,000, 5,000, and 6,000 lumens
- Housing available with passive air handling

APPLICATIONS

- Hospitals
- Offices
- Schools

WARRANTY

- Standard 5-year system, and 10 year LED warranty

OPTICS

Powder coated body in high-reflectance white. High-efficiency diffuser maximizes light distribution while providing diffusion of LED point sources.

ELECTRICAL

All components are UL recognized

MOUNTING

Holes provided for chain or hanger wire mounting support for T-Bar ceilings. Surface mount kits are also available (Consult factory for details.)

CONSTRUCTION

- Fixture materials are precision bent for added strength and rigidity
- Cold rolled steel body powder coated in high reflectance white.
- Access panel provided for easy wiring
- Shallow fixture design for easy of installation and a clean, professional look.

APPROVAL

- ETL Certified

PRODUCT KEY

Fixture Type	Fixture Size	Lumen Output	CRI & Colour Temperature	Driver Voltage	Options
BLRT					
	26	4	830	UNV	
		5	835	347	
		6	840		
			850		

Options

Air Handling	Mounting
H20 - Housing with Passive Air Handling	M15 - Surface Mount Kit

SPECIFICATIONS MAY CHANGE WITHOUT NOTICE



PRODUCT DIMENSIONS

End View

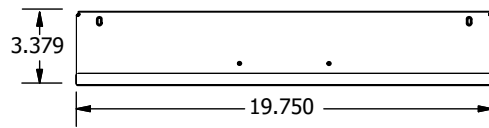

SideView

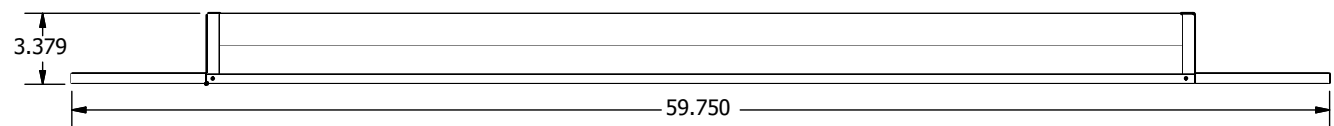

Wattage Chart

BLRT26 Wattage Chart		
Length	Lumens	Wattage
26	4.0	34.38
	5.0	41.15
	6.0	47.8

* Based on 4000K

* Based on UNV voltage

Project:
Type:
Date:
Product Code:
Approval:

*Stylish and performance driven
LED lighting.*



BLSDC - SPECIFICATIONS MAY CHANGE WITHOUT NOTICE

Superior-grade, recessed LED perimeter lighting fixture. Its ideal for indoor use where aesthetics, energy-efficiency and LED lighting is essential. Its narrow strip design with a modern profile makes it an ideal fixture for task lighting applications.

FEATURES

- Precision bent from high reflectance pre-painted white steel for enhanced performance and rigidity
- L70 of 120,000 hours
- Diffuser provides a uniform lighting surface while maximizing the total generated light
- Utility aluminum module mount aids in distributing heat

OPTIONS

- 0 - 10V dimming available
- Various lens available (consult factory)
- Available in 3000K, 3500K, 4000K and 5000K
- Lumen packages are available in 2000 and 4000 lumens
- Flange kit for drywall ceiling

APPLICATIONS

- Coves
- Hospitals
- Indoor recessed applications
- Offices
- Reception areas

APPROVALS

- Adheres to CSA and UL standards

OPTICS

Pre-painted body in high-reflectance white. High-efficiency diffuser maximizes light distribution while providing full diffusion of LED point sources. L70 of 120,000 hours.

ELECTRICAL

All components have met all regulatory approvals. Fixture is available in 120 - 277VAC and 347V options.

MOUNTING

Can be row mounted in a recessed drywall or t-bar application. Holes provided for chain or hanger wire mounting support for T-Bar ceilings.

CONSTRUCTION

Made of high quality and high reflectance pre-painted white steel. Utility grade aluminum module mount provides additional heat syncing capability. This fixture offers a white diffuser to provide uniform lighting while maximizing the total generated light.

PRODUCT DIMENSIONS

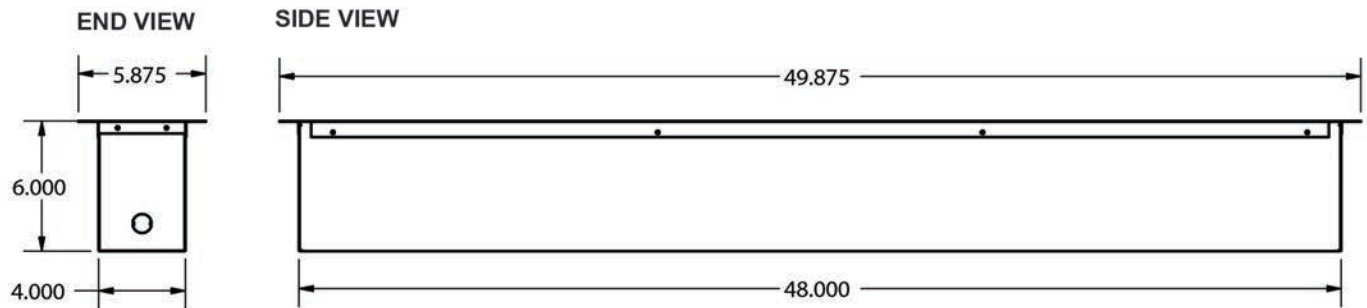

PRODUCT KEY

Fixture Type	Fixture Diameter	Lumen Output (in 1,000s)	Module Type	CRI & Colour Temperature	Driver Voltage	Options
BLSDC	4'	<input type="text"/> L	<input type="text"/>	<input type="text"/>	<input type="text"/>	<input type="text"/>
		2	Factory	830	UNV	
		4	Designated	835	347	
				840		
				850		

Wattage Chart		
LENGTH	LUMENS	WATTAGE
4'	2	19
	4	39

OPTIONS

Cords W3xx - 16/3 600V White (Specify length) W4xx - 16/3 600V Black (Specify length) W5xx - Power Cord Twist Lock Plug (Specify NEMA Code) W8xx - Power cord 3-Wire 120V 5-15P, 16/3	Lenses L19 - LC3 LED Frosted Lens L20 - Lens P12 Acrylic 0.123" Thick L25 - Eastman Chem Developmental Lens Mounting M7 - Mounting - End of Row (1 End) M8 - Mounting - Row Mounting Middle Section M9 - Mounting - Free Standing (2 Ends)	Dimming W23 - 0 - 10V No Leads (Standard) W24 - 0 - 10V with Leads
--	---	---

Project:
Type:
Date:
Product Code:
Approval:



* See notes below

BLSP

The BLSP is an LED linear strip fixture designed for surface and suspended mounting. It is well suited for indoor use where high efficiency, row-mountable task lighting is required. Its narrow strip design and modern profile make it an ideal fixture for task lighting applications.

FEATURES

- Full range of voltage options from 120-277V and 347V
- Narrow strip design allows for a sleek and modern look
- Specially designed extruded lens
- L70 of 200,000 hours

OPERATING TEMPERATURE

- -20°C to 35°C

OPTIONS

- 2', 4' and 8' lengths available
- 0 – 10V dimming standard
- Dimmable up to 10% light output
- Row-mounting available
- Available in 3000K, 3500K, 4000K, and 5000K

WARRANTY

- Standard 5 year system, and 10 year LED warranty

APPLICATIONS

- Display Cabinets
- Manufacturing
- Task Lighting
- Retail Stores

OPTICS

High-efficiency diffuser maximizes light distribution while providing diffusion of LED point sources and reducing glare

ELECTRICAL

All components are UL recognized

MOUNTING

Holes provided for surface and suspended mounting, as well as knock outs for row-mounting

CONSTRUCTION

- Pre-painted white steel fixture components are precision bent for added strength and rigidity
- Spot welded steel end caps for added rigidity
- Access panel provided for easy wiring
- Shallow fixture design for ease of installation and a clean, professional look

APPROVALS

- Damp Rated
- ETL Certified
- DLC Certified

PRODUCT DIMENSIONS

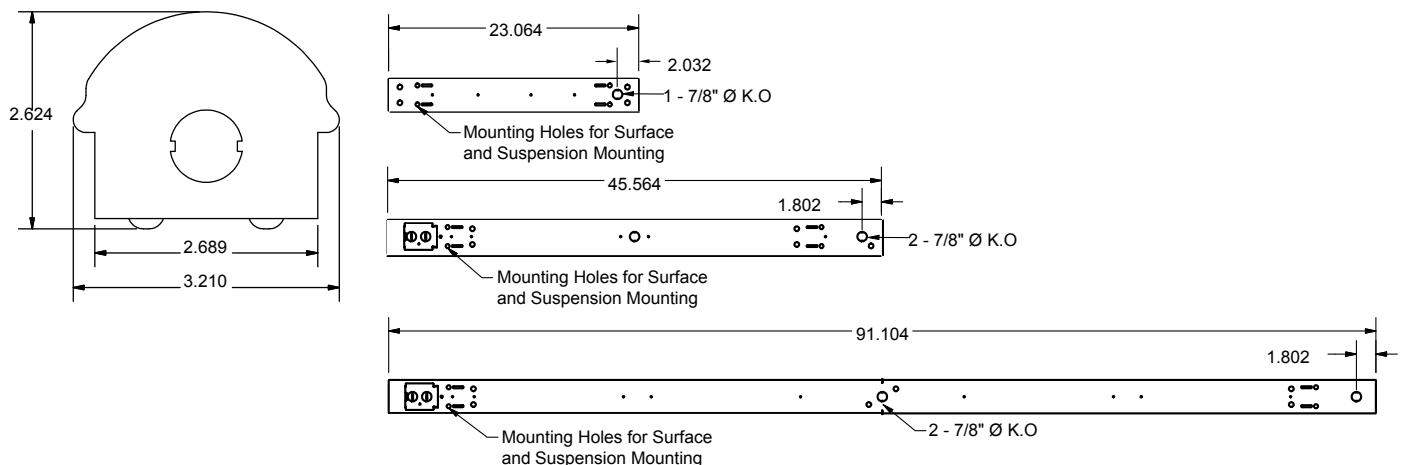

SPECIFICATIONS MAY CHANGE WITHOUT NOTICE

NOT ALL PRODUCTS ARE DLC LISTED. CONSULT FACTORY FOR MORE DETAILS



PRODUCT KEY

Fixture Type	Fixture Size	Lumen Output	CRI & Colour	Driver Voltage	Options
BLSP	-	-	L -	-	-

2'	1.25	830	UNV
	1.75	835	347
	2.25	840	
	2.75	850	
4'	2.5		
	3.5		
	4.5		
	5.5		
	6.5		
	7.5		
8'	5		
	7		
	9		
	11		
	13		
	15		

Options

Lenses L18 - Frosted Lens Wire Guard G1 - Curved White Wire Guard Temperature T0 - -40°C LED Driver	Mounting M1 - V-Hangers M3 - Aircraft Cable "Y-Toggle", 5 FT M7 - Row Mounting, End of Row M8 - Row Mounting, Middle of Row M23 - Aircraft Cable "Y-Toggle", 10 FT M24 - Single 3/4" Pendant Mount	Cords W3xx - 16/3 White Cord, Specify Length W4xx - 16/3 Black Cord, Specify Length W8xx - Power Cord 16/3, Specify Length and 15amp Plug Motion Sensor W53 - Snap in Motion Sensor
---	---	--

* Consult BJ Take for more motion sensor options and fixture options

BLSP Wattage Chart								
Length	Lumens	Wattage	Length	Lumens	Wattage	Length	Lumens	Wattage
2'	1.25	9	4'	2.5	22	8'	5.0	42
	1.75	13		3.5	30		7.0	59
	2.25	18		4.5	38		9.0	78
	2.75	23		5.5	43		11.0	86
				6.5	52		13.0	103
				7.5	60		15.0	120

* Based on UNV voltage

* Based on 4000K

* Actual wattages may vary

SPECIFICATIONS MAY CHANGE WITHOUT NOTICE

NOT ALL PRODUCTS ARE DLC LISTED. CONSULT FACTORY FOR MORE DETAILS

Project:
Type:
Date:
Product Code:
Approval:

Stylish, performance and long lasting quality.



BLSPC - SPECIFICATIONS MAY CHANGE WITHOUT NOTICE

Professional-grade surface-mounted LED cove strip fixture. It is ideal for indoor use, where high-efficiency, high-performance and ease of installation are required. Its narrow strip design with a modern profile makes it an ideal fixture for task lighting applications.

FEATURES

- Narrow strip design allows for a sleek and modern look
- L70 of 200,000 hours

OPTIONS

- 2', 4' and 8' lengths available
- 0 - 10V dimming standard
- Dimmable up to 10% light output
- Row-mounting available including staggered and continuous row-mounting
- Available in 3000K, 3500K, 4000K and 5000K

APPLICATIONS

- Display cabinets
- Manufacturing
- Task lighting
- Coves

APPROVALS

- ETL Certified
- Damp Rated

OPTICS

Pre-painted body in high-reflectance white. Optional wireguard is available.

ELECTRICAL

All components have met all regulatory approvals. Convenient knockout patterns for easy connections and through wiring. Fixture is available in 120 - 277VAC and 347V options.

MOUNTING

Can be row-mounted in continuous configurations. Holes provided for convenient surface mounting or chain-mounting.

CONSTRUCTION

Precision-formed, code gauge pre-painted, white steel. 0.020" nominal thick steel. Knock outs provide easy through wiring for row-mounted applications. Access panel for easy wiring.



PRODUCT DIMENSIONS

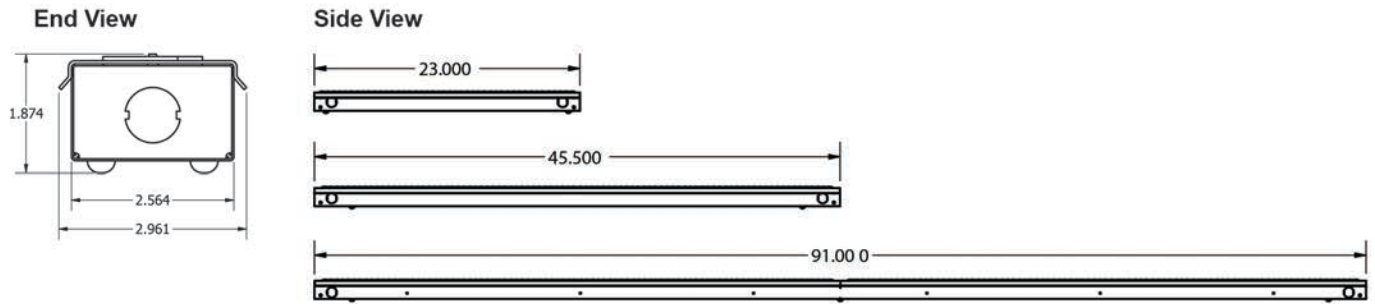

PRODUCT KEY

Fixture Type	Fixture Size	Lumen Output	Module Type	CRI & Colour Temperature	Driver Voltage	Options
BLSPC						
	2'	1	Factory	830	UNV	
		2	Designated	835	347	
	4'	2		840		
		4		850		
		6				
	8'	4				
		8				
		12				

BLSPC Wattages								
Length	Lumens	Wattage	Length	Lumens	Wattage	Length	Lumens	Wattage
2'	1.0	9	4'	2.0	13	8'	4.0	27
	2.0	17		4.0	29		8.0	57
				6.0	41		12.0	82

*Based on UNV voltage
*Based on 4000K

Options

Wire Guard G1 - Wire Guard (Painted White) *Consult BJ Take for more options	Mounting M1 - V-hangers M3 - Aircraft Cable "Y-Toggle", 5 FT M23 - Aircraft Cable "Y-Toggle", 10 FT	Cords W3xx - 16/3 White Cord, Specify Length W4xx - 16/3 Black Cord, Specify Length
---	---	--



Project:
Type:
Date:
Product Code:
Approval:

Stylish, performance and long lasting quality.



BLSPI - SPECIFICATIONS MAY CHANGE WITHOUT NOTICE

Quality-grade, surface and suspended mount LED strip fixture. It is ideal for indoor use, where high efficiency, row-mountable task lighting is required. Its narrow strip design with a modern profile makes it an ideal fixture for task lighting applications.

FEATURES

- Narrow strip design allows for a sleek and modern look
- Unique lens design aids in preventing dust from coming into contact with LEDs
- L70 of 200,000 hours

OPTIONS

- 2', 4' and 8' lengths available
- 0 - 10V dimming standard
- Dimmable up to 10% light output
- Row-mounting available including staggered and continuous row-mounting
- Available in 3000K, 3500K, 4000K and 5000K

APPLICATIONS

- Display cabinets
- Manufacturing
- Task lighting
- Retail Stores

APPROVALS

- ETL Certified
- Damp Rated

OPTICS

Pre-painted body in high-reflectance white. Frosted lens provides even light distribution. Specialized LED lens delivers a consistent light to the work surface that is both bright and significantly reduces eye strain.

ELECTRICAL

All components have met all regulatory approvals. Convenient knockout patterns for easy connections and through wiring. Fixture is available in 120 - 277VAC and 347V options.

MOUNTING

Can be row-mounted in continuous configurations. Holes provided for convenient surface mounting or chain-mounting.

CONSTRUCTION

Precision-formed, code gauge pre-painted, white steel. 0.030" nominal thick steel. End caps are spot welded and made from 0.030 pre-painted white steel for added rigidity. Frosted acrylic lens for even light distribution. Knock outs provide easy through wiring for row-mounted applications. Access panel for easy wiring.



PRODUCT DIMENSIONS

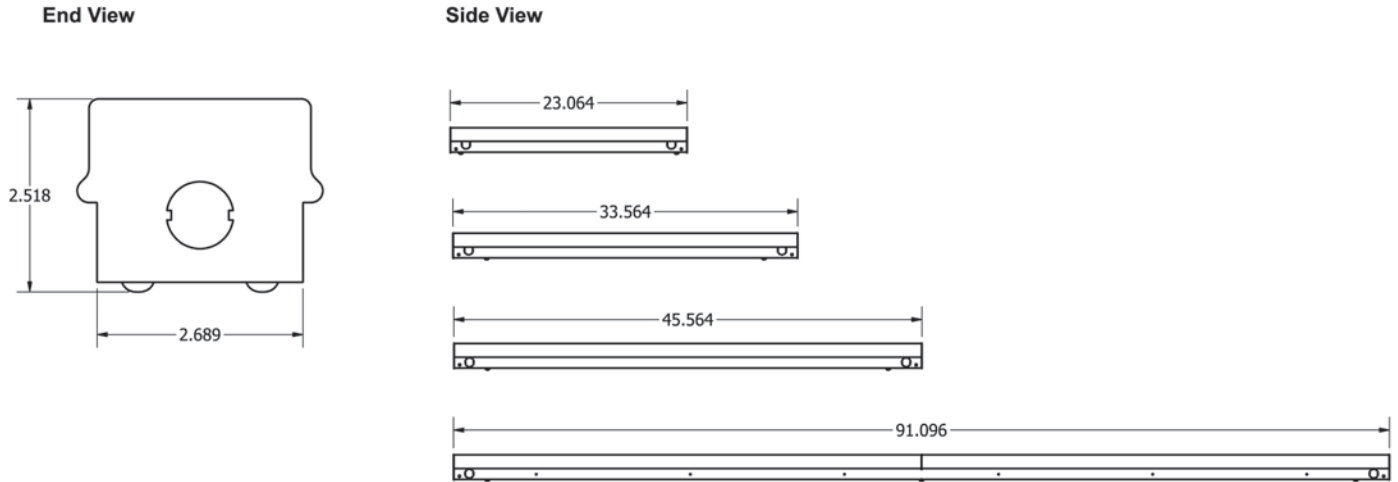

PRODUCT KEY

Fixture Type	Fixture Size	Lumen Output	Module Type	CRI & Colour Temperature	Driver Voltage	Options
BLSPI	-	-	L	-	-	-

2'	1.5
	2.5
	3.5
4'	2.5
	3.5
	4.5
	5.5
8'	6.5
	7.5
	5
	7
	9

Factory	830	UNV
Designated	835	347
	840	
	850	

BLSPI Wattages								
Length	Lumens	Wattage	Length	Lumens	Wattage	Length	Lumens	Wattage
2'	1.5	22	4'	2.5	22	8'	5.0	42
	2.5	26		3.5	30		7.0	59
	3.5	40		4.5	38		9.0	78
				5.5	42			
				6.5	60			
				7.5	68			

*Based on UNV voltage

*Based on 4000K

Options

Lenses L18 - Frosted Lens Wire Guard G1 - Wire Guard (Painted White) *Consult BJ Take for more options	Mounting M1 - V-Hangers M3 - Aircraft Cable "Y-Toggle", 5 FT M23 - Aircraft Cable "Y-Toggle", 10 FT Motion Sensor W53 - Standard Motion Sensor	Cords W1xx - 16/4 White Cord, Specify Length W2xx - 16/4 Black Cord, Specify Length W3xx - 16/3 White Cord, Specify Length W4xx - 16/3 Black Cord, Specify Length W8xx - Power Cord 16/3, Specify Length and 15amp Plug
--	---	---



Project:
Type:
Date:
Product Code:
Approval:

**BLWD**

The BLWD is an LED wrap fixture designed for surface and suspended mounting. It is well suited for use in office spaces and hallways where a clean, professional appearance is required.

FEATURES

- Full range of voltage options from 120-277V and 347V
- L70 of 200,000 hours
- Hinged frosted diffuser
- Fixture lensing provides an even light distribution through the use of 120 degree angle LED chips and a specially designed extruded lens

OPTIONS

- 0 – 10V dimming standard
- Available in 3000K, 3500K, 4000K, and 5000K
- Lumen packages are available in 2,000, 3,000, 4,000, 5,000 and 6,000 lumens

WARRANTY

- Standard 5 year system, and 10 year LED warranty

APPLICATIONS

- Hospitals
- Offices
- Schools

OPTICS

High-efficiency frosted diffuser maximizes light distribution while providing diffusion of LED point sources

ELECTRICAL

All components are UL recognized

MOUNTING

Holes provided for surface and suspended mounting

CONSTRUCTION

- Pre-painted white steel fixture components are precision bent for added strength and rigidity
- Access panel provided for easy wiring
- Shallow fixture design for ease of installation and a clean, professional look.

OPERATING TEMPERATURE

- -20°C to 35°C

APPROVALS

- ETL Certified
- DLC Certified

PRODUCT DIMENSIONS

End View

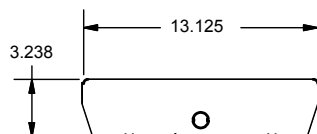

Side View

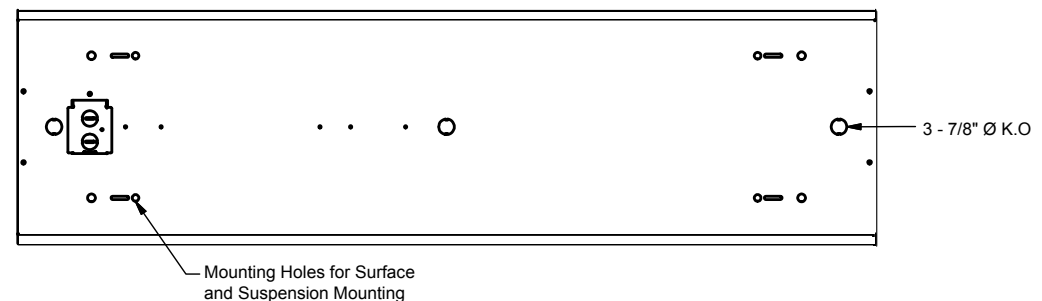
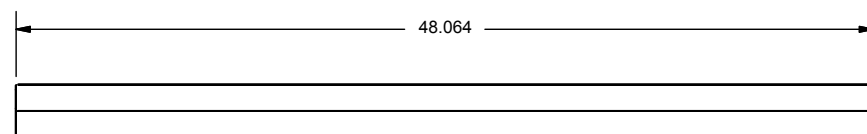

SPECIFICATIONS MAY CHANGE WITHOUT NOTICE



PRODUCT KEY

Fixture Type	Fixture Size	Lumen Output	CRI & Colour Temperature	Driver Voltage	Options
BLWD	4'				
		2	830	UNV	
		3	835	347	
		4	840		
		5	850		
		6			

Options

Lenses Blank - Standard Motion Sensor W12 - Standard Motion Sensor	Mounting M3 - Aircraft Cable "Y-Toggle", 5 FT M19 - Aircraft Cable "Y-Toggle", 15 FT M23 - Aircraft Cable "Y-Toggle", 10 FT M24 - Single 3/4" Pendant Mount	Cords W3xx - 16/3 White Cord, Specify Length W4xx - 16/3 Black Cord, Specify Length Wire Guard G1 - Wire Guard (Painted White)
---	--	--

* Consult BJ Take for more options

BLWD Wattage Chart		
Length	Lumens	Wattage
4'	2.0	17
	3.0	24
	4.0	32
	5.0	40
	6.0	48

* Based on UNV voltage

* Based on 4000K

SPECIFICATIONS MAY CHANGE WITHOUT NOTICE

Project:
Type:
Date:
Product Code:
Approval:

**BRLR**

The BRLR is an LED retrofit kit offering up to 50% in energy savings. It has been designed to convert existing 2x2, 1x4 and 2x4 recessed troffers from T8 or T12 to LED. Its flexibility and simple installation make it easy to take advantage of improved energy-efficiency and performance.

FEATURES

- Has a full range of voltage options from 120-277V and 347V
- L70 of 200,000 hours
- Fixture lensing provides an even light distribution through the use of 120 degree angle LED chips and a specially designed lens
- 10 minute installation time

OPTIONS

- 0 – 10V dimming standard
- Available in 3000K, 3500K, 4000K, and 5000K
- Lumen packages are available in 2,000, 3,000, 4,000, 5,000 and 6,000 lumens

APPLICATIONS

- Existing fluorescent 2x2, 1x4 and 2x4 recessed troffers

WARRANTY

- Standard 5 year system, and 10 year LED warranty

OPTICS

High-efficiency frosted diffuser maximizes light distribution while providing diffusion of LED point sources

ELECTRICAL

All components are UL recognized

MOUNTING

Holes provided for mounting inside existing fluorescent recessed troffers using self-tapping screws. Consult BJ Take for installation instructions.

CONSTRUCTION

- Pre-painted white steel fixture components are precision bent for added strength and rigidity
- Shallow design for ease of installation and a clean, professional look

APPROVALS

- ETL Certified
- DLC Certified

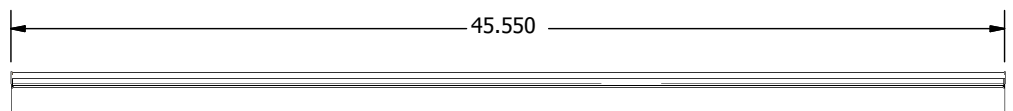
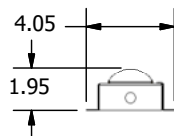
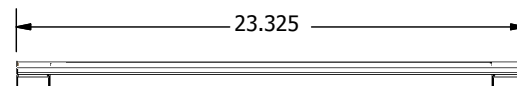
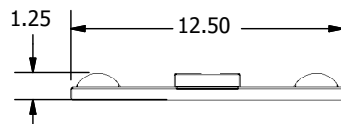
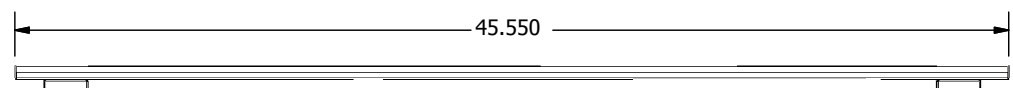
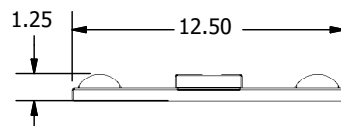
PRODUCT DIMENSIONS**14 Dimensions****22 Dimensions****24 Dimensions**

SPECIFICATIONS MAY CHANGE WITHOUT NOTICE



PRODUCT KEY

Retrofit Type	Fixture Size	Lumen Output	CRI & Colour Temperature	Driver Voltage
BRLR				

14 22	2	830	UNV
	2.5	835	347
	3	840	
	3.5	850	
	4		
24	4		
	4.5		
	5		
	5.5		
	6		

BRLR Wattages								
Length	Lumens	Wattage	Length	Lumens	Wattage	Length	Lumens	Wattage
14	2	15.7	22	2	15.7	24	4	31.4
	2.5	20.1		2.5	20.1		4.5	35.8
	3	24.9		3	24.9		5	40.3
	3.5	29.7		3.5	29.7		5.5	44.9
	4	34.9		4	34.9		6.0	49.7

* Based on UNV voltage
 * Based on 4000K
 * Actual wattages may vary

Project:
Type:
Date:
Product Code:
Approval:



BRLS

The BRLS is a LED retrofit kit offering up to 50% in energy savings. It has been designed to covert existing 4ft and 8ft commercial or industrial strip fixtures from T8 or T12 to LED. Its flexibility and simple installation make it easy to take advantage of improved energy-efficiency and performance.

FEATURES

- Has a full range of voltage options from 120-277V and 347V
- L70 of 200,000 hours
- Fixture lensing provides an even light distribution through the use of 120 degree angle LED chips and a specially designed lens
- 7-10 minute installation time

OPTIONS

- 0 – 10V dimming standard
- Available in 3000K, 3500K, 4000K, and 5000K
- Lumen packages are available in 2,000 to 8000 lumens

APPLICATIONS

- Existing fluorescent commercial and industrial style fixtures

WARRANTY

- Standard 5 year system, and 10 year LED warranty

OPTICS

High-efficiency frosted diffuser maximizes light distribution while providing diffusion of LED point sources

ELECTRICAL

All components are UL recognized

MOUNTING

Holes provided for mounting inside existing fluorescent recessed troffers using self-tapping screws. Consult BJ Take for installation instructions.

CONSTRUCTION

- Pre-painted white steel fixture components are precision bent for added strength and rigidity
- Shallow design for ease of installation and a clean, professional look

APPROVALS

- ETL Certified
- DLC Certified

PRODUCT DIMENSIONS

End View

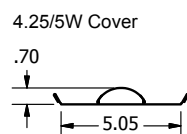
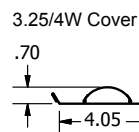
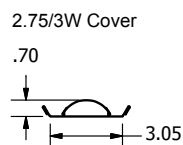

Side View

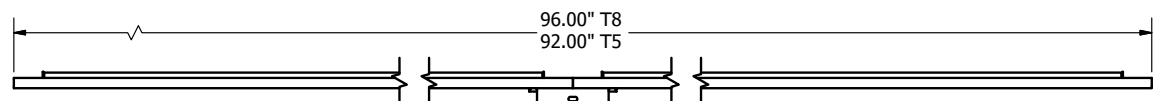
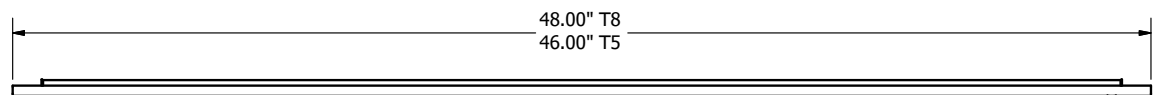

SPECIFICATIONS MAY CHANGE WITHOUT NOTICE



PRODUCT KEY

Retrofit Type	Fixture Length	Fixture Width	Fixture Type	Lumen Output	CRI & Colour Temperature	Driver Voltage
BRLS	-	-	W	-	L	-
	4	2.75/3	Blank - T8	4'	830	UNV
	8	3.25/4	T5		835	347
		4.25/5			840	
					850	
				4'/8'	4	
				8'	5	
					6	
					7	
					8	

BRLS Wattages					
Length	Lumens	Wattage	Length	Lumens	Wattage
4ft	2.0	15.7	8ft	4.0	31.4
	2.5	20.1		5.0	40.3
	3.0	24.9		6.0	49.7
	3.5	29.7		7.0	59.4
	4.0	34.9		8.0	69.8

* Based on 4000K

*Based on UNV voltage

* Actual wattages may vary

SPECIFICATIONS MAY CHANGE WITHOUT NOTICE



Vapour Tight Lighting

Project:
Type:
Date:
Product Code:
Approval:

Vapour resistance and performance driven LED lighting.



* See notes below

BLV - SPECIFICATIONS MAY CHANGE WITHOUT NOTICE

Superior-grade, suspended-mount LED enclosed and gasketed fixture. It is ideal for indoor or outdoor use where there is a high probability to exposure to dust, water or vapour. Its unique, IP67 certified body makes it ideal in environments where vapour-proof efficiency and performance are a factor.

FEATURES

- Fibreglass body with neoprene gasket ensures a dust and water resistant seal
- 3000K, 3500K, 4000K and 5000K light colours available
- LEDs are rated for up to 120,000 hours (L70)
- Diffuser provides a uniform lighting surface while maximizing the total generated light

OPTIONS

- 2', 4' and 8' lengths available
- Lumen packages are available in 8000, 10000, 12000, 14000, 15000 lumens

APPLICATIONS

- Food processing plants
- Garages
- Underground parking facilities

APPROVALS

- DLC listed (consult BJ Take for details)
- ETL listed product
- Meets IP67 standards

OPTICS

High-efficiency diffuser maximizes light distribution while providing full diffusion of LED point sources.

ELECTRICAL

All components have met all regulatory approvals. Convenient knockout patterns for easy connections and through wiring. Fixture is available in 120 - 277VAC and 347V options.

MOUNTING

Can be row-mounted using a suspended or surface-mount configuration. V-shaped mounting brackets for suspended applications.

CONSTRUCTION

Fibreglass enclosure with neoprene gasket ensures a dust and water resistant seal. Clear acrylic lens ensures a maximum light path is achieved. Available with high-reflectance white or specular aluminum reflector. End knock-outs allow for continuous wiring.

* Not all products are DLC listed. Consult Factory for more details.



PRODUCT DIMENSIONS

End View

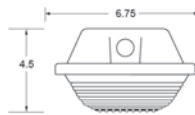

Side View

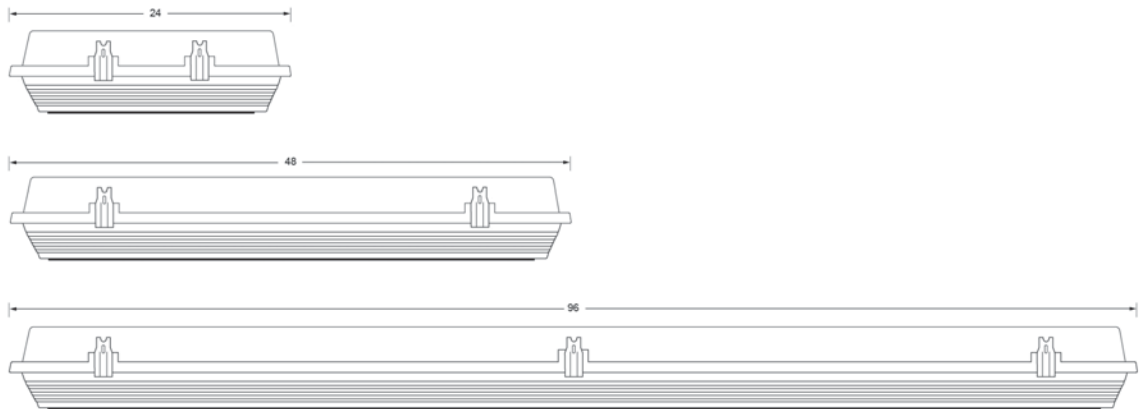

PRODUCT KEY

Fixture Type	Fixture Sizes	Lumen Output (in 1,000s)	Module Type	CRI & Colour Temperature	Driver Voltage	Options
BLV	<div>2'</div> <div>4'</div> <div>8'</div>	<div>2</div> <div>3</div> <div>4</div> <div>8</div> <div>10</div> <div>12</div> <div>14</div> <div>15</div> <div>6</div> <div>8</div> <div>12</div> <div>16</div>	<div>Factory</div> <div>Designated</div>	<div>830</div> <div>835</div> <div>840</div> <div>850</div>	<div>UNV</div> <div>347</div>	

Wattage Chart

LENGTH	LUMENS	WATTAGE	LENGTH	LUMENS	WATTAGE	LENGTH	LUMENS	WATTAGE
2'	2	17	4'	4	40	8'	6	48
	3	24		5.5	52		8	68
	4	36		7	78		12	96
				7.5	74		15	136

* Delivered Lumens

OPTIONS		
Dimming W23 - 0-10V No Leads (Standard) W24 - 0-10V With Leads	Lens L16 - Shallow Ribbed Frosted Arylic Lens L46 - Deep Frosted Arylic Smooth Lens L61 - Clear Acrylic Drop Lens (CT2-CIRA)	Cords W3XX - Flexible Whip - 16/3 600V White (XX - Length) W4XX - Flexible Whip - 16/3 600V Black (XX - Length) W5XX - Power Cord - 16/3 White (XX Length) NEMA Code W6XX - Power Cord Set, 3-Wire 120V Plug, 14/3 (XX - Length) W8XX - Power Cord Set, 3-Wire 120V Plug, 18/3 White (XX - Length)

* Not all products are DLC listed. Consult Factory for more details.



Project:
Type:
Date:
Product Code:
Approval:

*Performance driven LED
vapour proof lighting.*



*Consult BJ Take for premium list

BLVN - SPECIFICATIONS MAY CHANGE WITHOUT NOTICE

Superior-grade, narrow body suspended-mount vapour proof LED fixture. It is ideal for indoor or outdoor use where there is a high probability of exposure to dust, water or vapour. Its unique, IP67 certified body makes it ideal in environments where vapour-proof efficiency and performance are a factor.

FEATURES

- Fibreglass body with neoprene gasket ensures a dust and water resistant seal
- 3000K, 3500K, 4000K and 5000K light colours available
- L70 of 200,000 hours
- Diffuser provides a uniform lighting surface with both polycarbonate and acrylic options
- 0-10V Dimming Standard

OPTIONS

- Available in 3000K, 3500K, 4000K and 5000K
- Lumen packages are available in 2500, 3500, 4500, and 5500 lumens

APPLICATIONS

- Food processing plants
- Manufacturing
- Schools
- Storage areas
- Underground parking facilities
- Warehouse facilities

OPTICS

L70 of 200,000 hours. High-efficiency diffuser maximizes light distribution while providing full diffusion of LED point sources.

ELECTRICAL

All components have met all regulatory approvals. Fixture is available in 120 - 277V and 347V.

MOUNTING

Can be suspended or surface-mounted.

CONSTRUCTION

Fibreglass enclosure with neoprene gasket ensures a dust and water resistant seal. Frosted acrylic lens for even light distribution. End plugs allow for continuous wiring.

APPROVALS

- ETL listed product
- Meets IP67 standards
- DLC Listed

PRODUCT DIMENSIONS

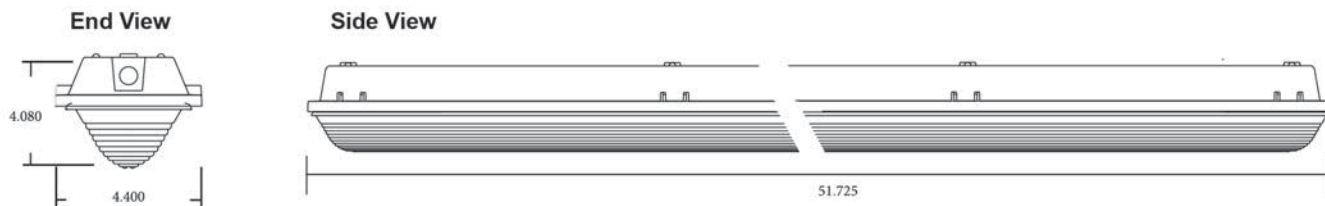

PRODUCT KEY

Fixture Type	Fixture Size	Lumen Output	CRI & Colour Temperature	Driver Voltage	Options
BLVN	4'				
		2.5	830	UNV	
		3.5	835	347	
		4.5	840		
		5.5	850		

Options

Lenses L16 - Ribbed Frosted Acrylic Lens L17 - Ribbed Clear Acrylic Lens L26 - Ribbed Clear Polycarbonate Lens L64 - Ribbed Frosted Polycarbonate Lens *Consult BJ Take for more options	Mounting M3 - Aircraft Cable "Y-Toggle", 5 FT M23 - Aircraft Cable "Y-Toggle", 10 FT Motion Sensor W12 - Standard Motion Sensor W26 - Motion Sensor with Photocell W30 - IP Rated Motion Sensor	Cords W1xx - 16/4 White Cord, Specify Length W2xx - 16/4 Black Cord, Specify Length W3xx - 16/3 White Cord, Specify Length W4xx - 16/3 Black Cord, Specify Length W5xx - Power Cord 16/3, Specify Length and NEMA Code
--	---	--

BLVN Wattages						
Length	Lumens	Wattage	Delivered Lumens (5000K)	Delivered Lumens (4000K)	L/W (5000K)	L/W (4000K)
4'	2.5	16.9	2,278	2,221	134.7	131.3
	3.5	26.6	3,598	3,509	135.1	131.7
	4.5	34.2	4,502	4,391	131.5	128.2
	5.5	41.9	5,702	5,561	136.2	132.9

*Based on UNV voltage

*Based on a ribbed frosted acrylic lens